

24TH STREET

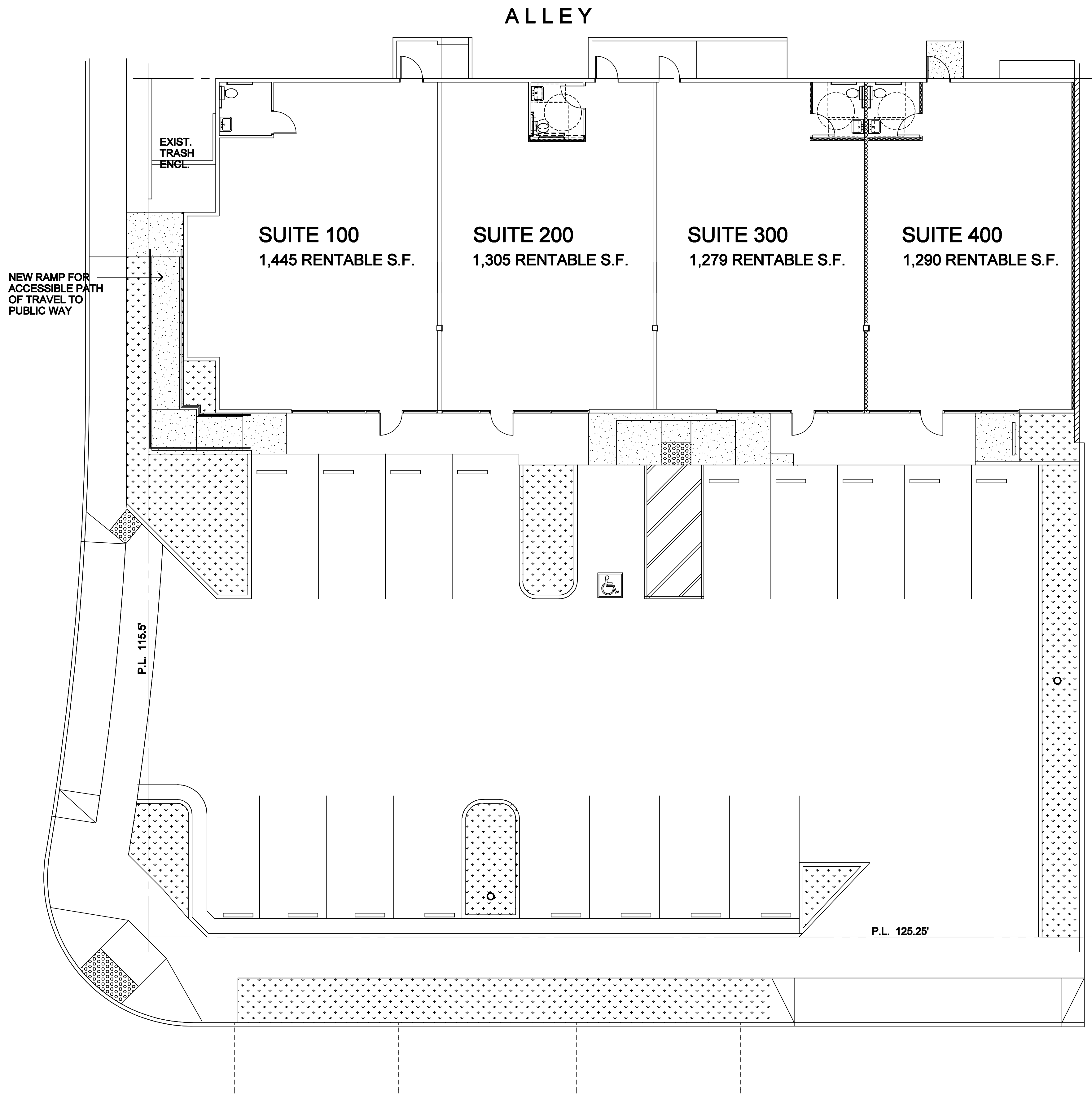

M STREET

| | |
|---------------------------------|--------------|
| SITE AREA: | 14,472.15 SF |
| BUILDING AREA: | 5,319 SF |
| PARKING REQUIRED: SPR 1222-C | 24 SPACES |
| PARKING PROVIDED: | |
| ONSITE | 18 STALLS |
| OFFSITE | 3 STALLS |
| TOTAL | 21 STALLS |



KSA GROUP ARCHITECTS

4660 American Avenue Suite 200
Bakersfield, California 93309
(661) 834-1331

Derek Holdsworth AIA C 8675

2401 "M" STREET
NWC 24th & "M" ST.
BAKERSFIELD, CA

DUCKETT-WILSON
DEVELOPMENT CO.
11150 SANTA MONICA BLVD
SUITE 760
LOS ANGELES, CA 90025

Every reasonable effort has been made in the preparation of these documents to ascertain and comply with all applicable codes and ordinances. However, in that these requirements are subject to change and interpretation, no warranty is given or implied relative to these documents level of compliance. Furthermore, nothing shown in or omitted from these documents shall relieve the contractor from full compliance with any such codes and ordinances.

Before commencement of work, these documents shall be reviewed by the contractor for any discrepancies or conflicts in dimensions, notes, or references. Any items that become apparent during this review process or during construction shall be referred immediately to the Architect for clarification. Any work proceeding without such notification shall become the responsibility of the contractor.

KSA GROUP ARCHITECTS expressly reserves its copyright and other property rights in these ideas, designs and documents which are not to be reproduced, changed, or copied in any form, nor assigned to any third party, without first obtaining KSA GROUP ARCHITECTS' express written permission.

COPYRIGHT 2021

| | | |
|-----------|-------------|------|
| | | |
| | | |
| | | |
| | | |
| | | |
| | | |
| | | |
| | | |
| No. | Description | Date |
| Revisions | | |

LEASING PLAN

Scale:
Job No:
2991
Date:
4/11/22

Sheet No:
LP1
of
sheets